

12.3 D.114 C2 S.T.R.A.JET

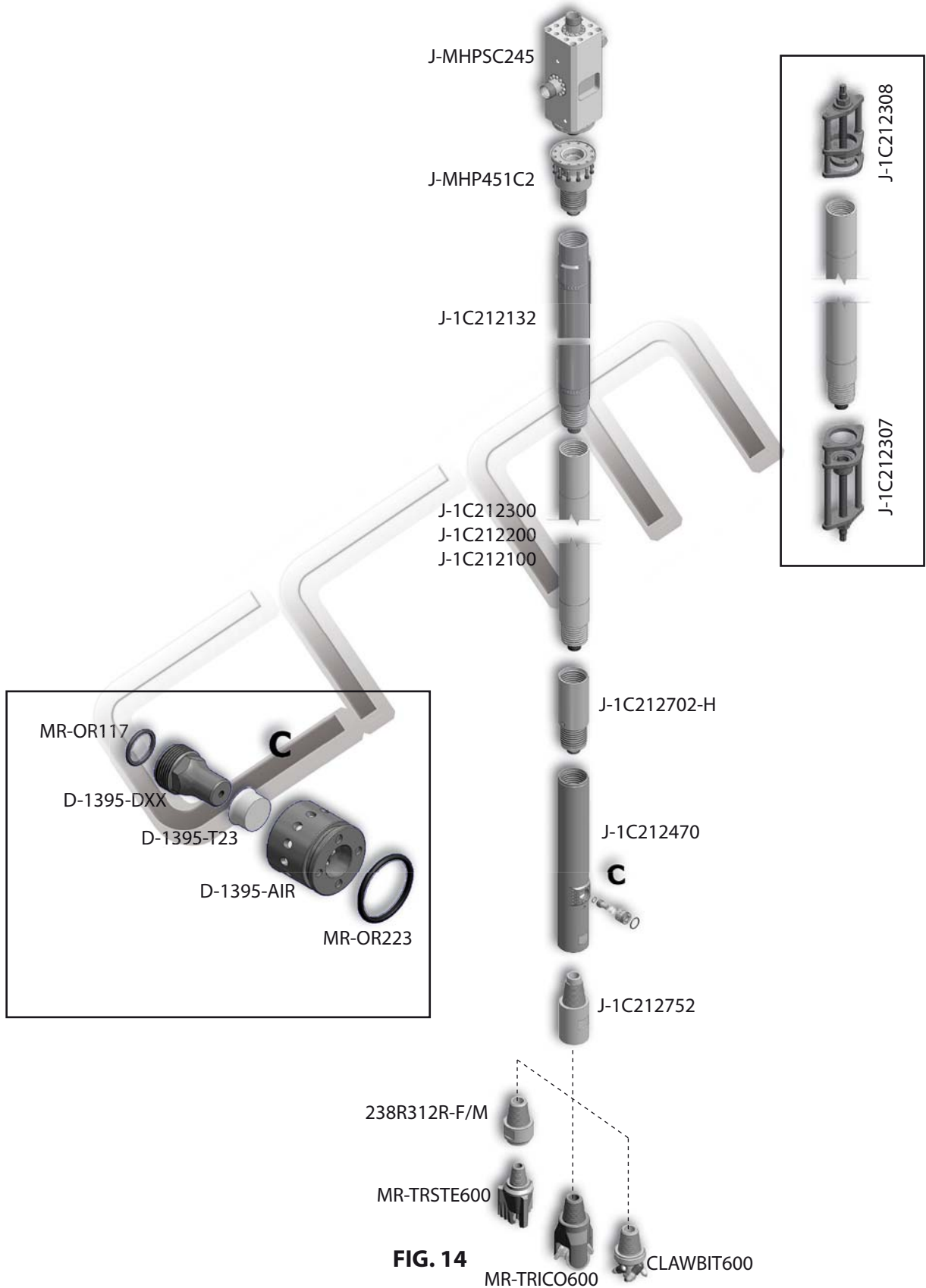

FIG. 14



D.114 C2 S.T.R.A.JET (STRAIGHT TURBULENCE REDUCING APPLIANCE) - REF. FIG. 14

CODICE CODE	DESCRIZIONE	DESCRIPTION	EURO/CAD EURO/EACH	% SC. % DISC.	PESO WEIGHT
J-MHPSC245	TESTA A.P. MODULARE D. 45 C2 (CEMENTO 900 L/min-560 bar; ARIA 21000 L/min-17-24 bar)	MODULAR H.P. SWIVEL D. 45 C2 (GROUT 900 L/min-560 bar; AIR 21000 L/min-17-24 bar)			48
J-MHP451C2	RIDUZIONE TESTA A.P. MODULARE D.114 C2	MOD. SWIVEL ADAPTER D. 114 C2			12
◇◇◇◇◇◇◇◇◇◇◇◇◇◇◇◇					
J-1C212300	ASTA D. 114X3000 C2	ROD. D. 114X3000 C2			66
J-1C212200	ASTA D. 114X2000 C2	ROD. D. 114X2000 C2			47
J-1C212100	ASTA D. 114X1000 C2	ROD. D. 114X1000 C2			26
J-1C212702-H	RACCORDO D. 114 C2 H.D. CON VALVOLA	ADAPTER D. 114 C2 H.D. C/VAL. NO RET.			11
J-1C212470	MONITOR S.T.R.A. JET	S.T.R.A. JET NOZZLE HOLDER			46
J-1C212752	PORTASCALPELLO D. 114 C2 MAX C/V	BIT ADAPTER D. 114 C2 MAX C/V			12,5
D-1395-AIR	UGELLO ARIA D. 23 S.T.R.A.JET	S.T.R.A.JET AIR NOZZLE D. 23			0,25
D-1395-D45	UGELLO CEM. S.T.R.A. JET D. 4.5	S.T.R.A. JET GROUT NOZZLE D. 4.5			0,16
D-1395-D50	UGELLO CEM. S.T.R.A. JET D. 5.0	S.T.R.A. JET GROUT NOZZLE D. 5.0			0,16
D-1395-D55	UGELLO CEM. S.T.R.A. JET D. 5.5	S.T.R.A. JET GROUT NOZZLE D. 5.5			0,16
D-1395-D60	UGELLO CEM. S.T.R.A. JET D. 6.0	S.T.R.A. JET GROUT NOZZLE D. 6.0			0,16
D-1395-D65	UGELLO CEM. S.T.R.A. JET D. 6.5	S.T.R.A. JET GROUT NOZZLE D. 6.5			0,16
D-1395-D70	UGELLO CEM. S.T.R.A. JET D. 7.0	S.T.R.A. JET GROUT NOZZLE D. 7.0			0,16
D-1395-D75	UGELLO CEM. S.T.R.A. JET D. 7.5	S.T.R.A. JET GROUT NOZZLE D. 7.5			0,16
D-1395-D80	UGELLO CEM. S.T.R.A. JET D. 8.0	S.T.R.A. JET GROUT NOZZLE D. 8.0			0,16
D-1395-D85	UGELLO CEM. S.T.R.A. JET D. 8.5	S.T.R.A. JET GROUT NOZZLE D. 8.5			0,16
D-1395-D90	UGELLO CEM. S.T.R.A. JET D. 9.0	S.T.R.A. JET GROUT NOZZLE D. 9.0			0,16
D-1395-T23	TAPPO D. 23 UGELLO ARIA A PERDERE	D. 23 REPLACEABLE PLUG			0,05
MR-OR117	GUARN. O-RING 117	O-RING 117 SEAL			-
MR-OR223	GUARN. O-RING 223	O-RING 223 SEAL			-
◇◇◇◇◇◇◇◇◇◇◇◇◇◇◇◇					
CLAWBIT600	CLAWBIT D. 152 (6") 3" 1/2 A.R. M.	CLAW-BIT D. 152 (6") 3" 1/2 AR M.			12
MR-TRIC0600	TRICONO D. 6"-1/2 L2	ROCK BIT D. 6"-1/2 L2			9
238R312R-F/M	RID. 2" 3/8 AR-3" 1/2 AR F/M	ADAPTER 2"-3/8 AR BOX/PIN 3"-1/2 AR			6
MR-TRSTE600	TRILAMA STEP D. 6" (2"-3/8 AR M.)	DRAG BIT D. 6" (2" 3/8 AR PIN)			5
◇◇◇◇◇◇◇◇◇◇◇◇◇◇◇◇					
J-MHP451C2-A	KIT RICAMBI MODULAR SWIVEL C2	C2 MODULAR SWIVEL SPARE KIT			-
J-MHP451C2-B	KIT GUARNIZ. MODULAR SWIVEL C2	C2 MODULAR SWIVEL SEAL KIT			-
J-1C212311	KIT GUARN. ASTA D. 114 C2	ROD SEAL KIT			-
J-1C212703	KIT GUARN. RAC. VAL. D. 114 C2	NOZZLE HOLDER ADAPTER SEAL KIT			-

ACCESSORI - ACCESSORIES

CODICE CODE	DESCRIZIONE	DESCRIPTION	EURO/CAD EURO/EACH	% SC. % DISC.	PESO WEIGHT
J-1C212307	ESTRATTORE ASTA	ROD EXTRACTOR			10
J-1C212308	ESTRATTORE ASTA	ROD EXTRACTOR			9